

CERTIFICATE OF LOCATION OF GOVERNMENT CORNER

EAST QUARTER Corner of Section 17, Township 106, Range 39, 5TH P.M.

STATE OF MINNESOTA, County of MURRAY

At the corner location shown on the sketch:

On _____ found a _____
DATE

left monument as found, lowered monument, removed monument (explain)

On 10/14/15 placed a survey spike with seal #50343
DATE

SKETCH OF REFERENCE TIES

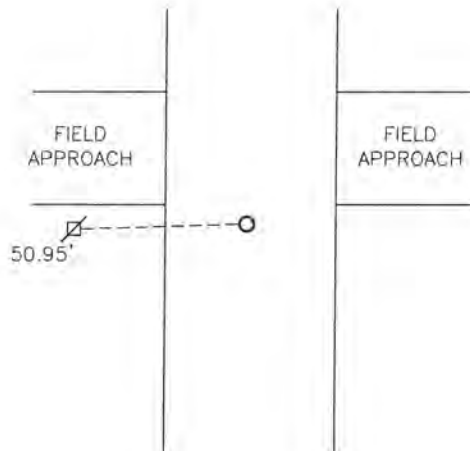

Minnesota State Plane Coordinate
System Murray County Datum
NAD83 (1996)

N: 150340.460
E: 558889.110

Nail and seal in utility pole West 50.95'

Statement of evidence relative to this corner location is on back of page.

I hereby certify that this document and the data contained herein was prepared by me or under my direct supervision.

[Signature] 3-21-16
SIGNATURE DATE

Registration No. 50343

- Land Surveyor, Professional Engineer
 County Surveyor, County Engineer

OFFICE OF THE COUNTY RECORDER

County of MURRAY

I hereby certify that this document was filed in the Co. Recorders office at 11:00 A.M. on the 18TH day of OCTOBER A.D. 2016

County Recorder Evelyn C. Larson

By _____, Deputy

DOCUMENT NO. _____

Statement of Evidence

In August, 1861, Wellman and Smoot did the original subdivision of the township.

On June 24, 1913, J.W. Woolstencroft recorded the corner to be equal distances between section corners.

(No Date), Murray County Highway Department plans shows stationing to the corner.

On November 8, 2008, Zieske Land Surveying located an iron monument at the corner.

On October 14, 2015, Bueltel-Moseng Land Surveying set a survey spike with seal #50343 by using Zieske coordinates. It is within 1' of distance from the southeast corner of Section 17-106-39 as shown on Murray County Highway Department plans. It is 1'± west of centerline of road and in line with fence of west side of Section 17.